

# Gulf-27

## SPECIFICATIONS

LOA	27'2"
LWL	22'6"
LEAD BALLAST	2,750
DIS	6,900
I	35'
P	29'6"
HEADROOM	6'1"
BEAM	9'4"
DRAFT	4'2"

Some items shown are optional.

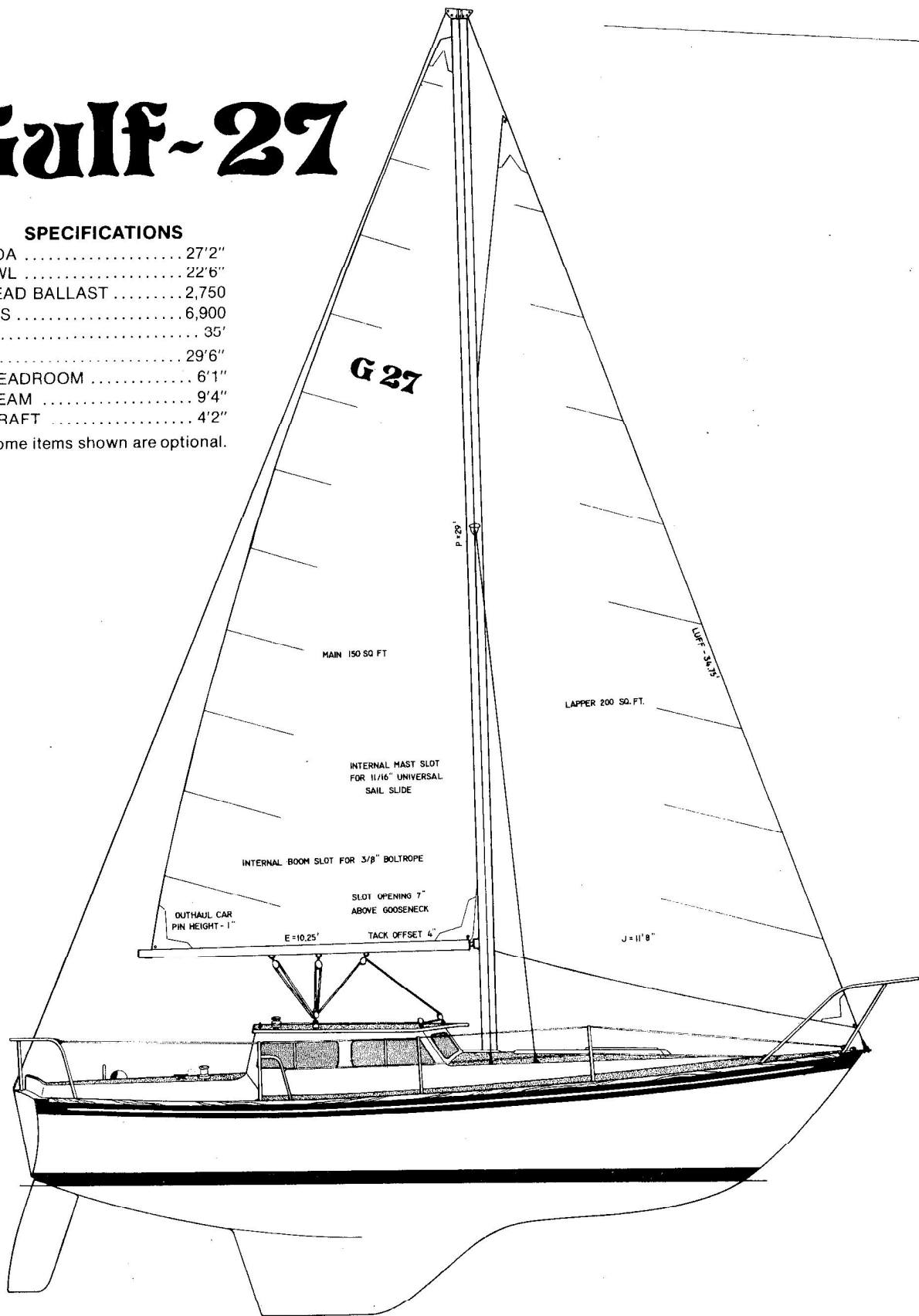

# **GULF-27 CLASSIC PILOT-HOUSE CRUISER**

The Gulf-27 was designed by Capital Yachts for the person desiring the comforts of traditional boat design and the sailing characteristics of modern sailboat technology. Inspired by the time-proven Gulf-32, the Gulf-27 has a pilot-house deck configuration which provides a light and airy cabin and allows the option of inside wheel steering. The hull and deck are completely hand laid-up from the highest quality fiberglass and gel-coat materials. The deck is reinforced with core sections and plywood. The hull to deck joint is trimmed with a teak cap rail.

The Gulf-27 is delivered with the following:

## **STANDARD EQUIPMENT**

**2 CYL. DIESEL ENGINE INBOARD, APPROX. 15 H.P.**

**• WINCH PACKAGE:**

2 primary winches in cockpit  
(2 speed geared)

Jib halyard winch

1 mainsheet winch w/cleat

2 winch handles (non locking)

- DELUXE LAMINATED WOOD TILLER
- BOW PULPIT W/MID RAIL
- STERN PULPIT
- BOW ROLLER
- FOREPEAK CHAINLOCKER MOLDED IN W/DRAIN
- 2 PELICAN HOOKS
- LIFELINES & STANCHIONS
- SPECIAL MAST AND BOOM W/ANODIZED PARTS
- ADJUSTABLE OUTHAUL
- DOUBLE LOWER SHROUDS
- INBOARD GENOA TRACKS WITH 2 SLIDE BLOCKS
- 8 STAINLESS STEEL TURNBUCKLES
- EXTERIOR WOOD TRIM TEAK
- NATURAL WOOD BULKHEADS AND FACINGS
- FIBERGLASS HATCH
- WATER TANK APPROX. 20 GAL.
- FUEL TANK APPROX. 20 GAL.
- ALL THRU HULLS W/ANTI CORROSIVE VALVES
- COCKPIT ENGINE ACCESS HATCH
- HINGED COCKPIT COMPANIONWAY DOORS

- FILLER ON DECK FOR FUEL TANK
- FWD. SLIDE HATCH
- COVE STRIP & BOOT TOP CHOICE OF COLOR
- LARGE COCKPIT SAIL & SAFETY GEAR LOCKERS
- MANUAL BILGE PUMP W/VALVE TO ICE BOX

**STANDARD INTERIOR**

- FOLD AWAY DINETTE TABLE STORES ON BULKHEAD
- TWO BURNER STOVE (ALCOHOL) FLUSH MOUNT
- STAINLESS STEEL SINK W/FOOT PUMP
- INSULATED ICE BOX W/DRAIN CONNECTED TO BILGE PUMP
- 4" FABRIC CUSHIONS
- SOFT PADDED HEAD LINER
- CABINET DRAWERS & DROP DOOR ACCENTED W/SEA RAIL TRIM
- BERTHS: 1 SINGLE & 2 DOUBLES
- DRY STORAGE COMPARTMENTS UNDER BERTHS AND DINETTE AREA
- LARGE HANGING LOCKER W/DRAWERS
- HEAD COMPARTMENTS W/SKYLIGHT-TOP AND BOTTOM STORAGE COMPARTMENTS
- SINK IN HEAD AREA
- COLD WATER SHOWER W/MANUAL FOOT PUMP
- WOOD HEAD DOOR
- FOLDING FABRIC DOOR FORWARD (TO MATCH CUSHIONS)
- NAVIGATIONAL LIGHTS & INTERIOR LIGHTS
- TEAK & HOLLY SOLE
- OWNER'S MANUAL & SAFETY TOOL BOX

# **GULF-27 CLASSIC PILOT-HOUSE CRUISER**

The Gulf-27 was designed by Capital Yachts for the person desiring the comforts of traditional boat design and the sailing characteristics of modern sailboat technology. Inspired by the time-proven Gulf-32, the Gulf-27 has a pilot-house deck configuration which provides a light and airy cabin and allows the option of inside wheel steering. The hull and deck are completely hand laid-up from the highest quality fiberglass and gel-coat materials. The deck is reinforced with core sections and plywood. The hull to deck joint is trimmed with a teak cap rail.

The Gulf-27 is delivered with the following:

## **STANDARD EQUIPMENT**

### **2 CYL. DIESEL ENGINE INBOARD, APPROX. 15 H.P.**

#### **• WINCH PACKAGE:**

2 primary winches in cockpit  
(2 speed geared)

Jib halyard winch

1 mainsheet winch w/cleat

2 winch handles (non locking)

- DELUXE LAMINATED WOOD TILLER
- BOW PULPIT W/MID RAIL
- STERN PULPIT
- BOW ROLLER
- FOREPEAK CHAINLOCKER MOLDED IN W/DRAIN
- 2 PELICAN HOOKS
- LIFELINES & STANCHIONS
- SPECIAL MAST AND BOOM W/ANODIZED PARTS
- ADJUSTABLE OUTHAUL
- DOUBLE LOWER SHROUDS
- INBOARD GENOA TRACKS WITH 2 SLIDE BLOCKS
- 8 STAINLESS STEEL TURNBUCKLES
- EXTERIOR WOOD TRIM TEAK
- NATURAL WOOD BULKHEADS AND FACINGS
- FIBERGLASS HATCH
- WATER TANK APPROX. 20 GAL.
- FUEL TANK APPROX. 20 GAL.
- ALL THRU HULLS W/ANTI CORROSIVE VALVES
- COCKPIT ENGINE ACCESS HATCH
- HINGED COCKPIT COMPANIONWAY DOORS

- FILLER ON DECK FOR FUEL TANK

- FWD. SLIDE HATCH

- COVE STRIP & BOOT TOP CHOICE OF COLOR

- LARGE COCKPIT SAIL & SAFETY GEAR LOCKERS

- MANUAL BILGE PUMP W/VALVE TO ICE BOX

#### **STANDARD INTERIOR**

- FOLD AWAY DINETTE TABLE STORES ON BULKHEAD

- TWO BURNER STOVE (ALCOHOL) FLUSH MOUNT

- STAINLESS STEEL SINK W/FOOT PUMP

- INSULATED ICE BOX W/DRAIN CONNECTED TO BILGE PUMP

- 4" FABRIC CUSHIONS

- SOFT PADDED HEAD LINER

- CABINET DRAWERS & DROP DOOR ACCENTED W/SEA RAIL TRIM

- BERTHS: 1 SINGLE & 2 DOUBLES

- DRY STORAGE COMPARTMENTS UNDER BERTHS AND DINETTE AREA

- LARGE HANGING LOCKER W/DRAWERS

- HEAD COMPARTMENTS W/SKYLIGHT-TOP AND BOTTOM STORAGE COMPARTMENTS

- SINK IN HEAD AREA

- COLD WATER SHOWER W/MANUAL FOOT PUMP

- WOOD HEAD DOOR

- FOLDING FABRIC DOOR FORWARD (TO MATCH CUSHIONS)

- NAVIGATIONAL LIGHTS & INTERIOR LIGHTS

- TEAK & HOLLY SOLE

- OWNER'S MANUAL & SAFETY TOOL BOX

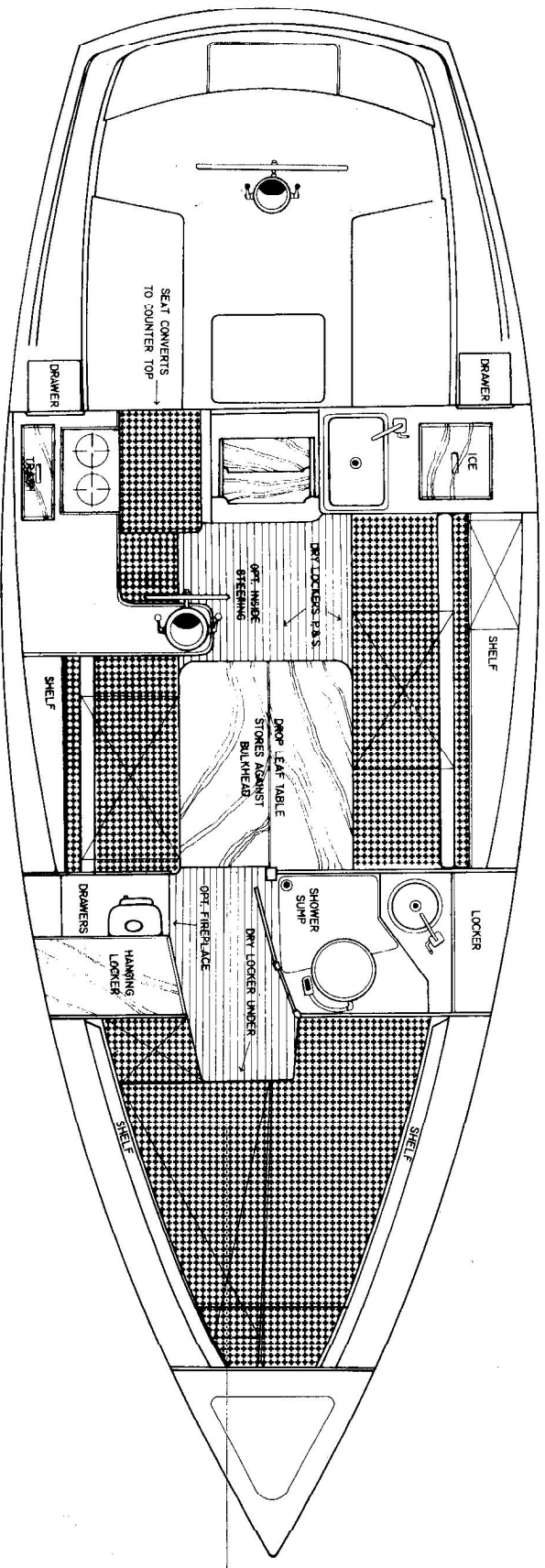
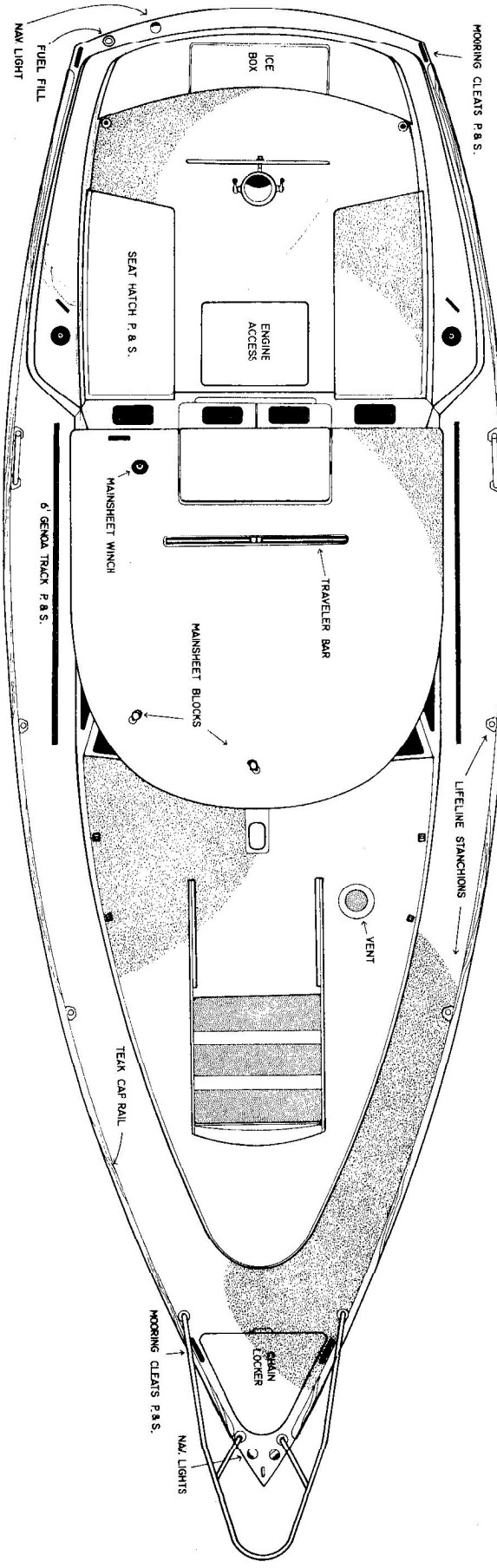

Some items shown are optional.